

# Stormwater management

## Stormwater treatment

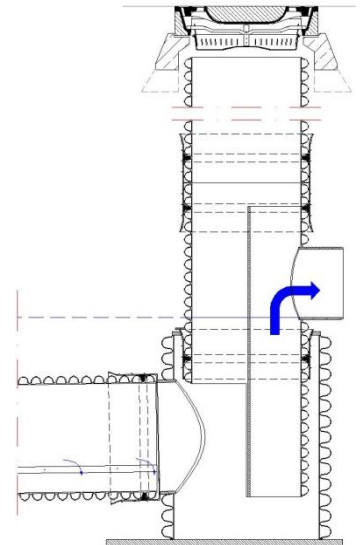

III.: SediPipe L target shaft

### SediPipe® L

#### Stormwater treatment system

**Underground treatment system for polluted stormwater; system consisting of start shaft and target shaft DN 800, sedimentation path DN 600 with lower flow separator. Inlet and outlet on the same level, inlet can be rotated 360°, flow direction can be adjusted to a desired angle between 90° and 270° on site.**

#### Technical data

Application:	For the treatment of polluted stormwater runoff for large areas of up to max. 4.44 ha according to DWA-M 153 and up to max. 16.67 ha according to DWA-A 102-2/BWK-A 3.			
Material / raw material:	PP (polypropylene)			
Specification:	Systems for stormwater treatment according to DWA-M 153 types D 21, D 24 or D 25, with proof of equality as compared to stormwater sedimentation tanks (NRW) Specially developed detection method according to section 6.1.3.4 DWA-A 102-2/BWK-A 3-2, (dwell time method) Verifications by HTWK Leipzig, ifs Hannover, LGA Würzburg, IKT Gelsenkirchen, TAUW / TU Delft, FH Münster			
Operating principle:	Sedimentation of coarse and fine particles in the long and tubular sedimentation chamber; the lower flow separator prevents remobilisation of the deposited particles during heavy rainfalls, additional protection against spills during dry weather, with temporary storage of light liquids in the target shaft.			
System types:	600/6	600/12	600/18	600/24
Outside diameter $D_o$ sedimentation pipe [mm]	685	685	685	685
Inside diameter $D_i$ sedimentation pipe [mm]	596	596	596	596
Total length of the system: [m]	7.96	13.98	20.03	26.08
Nominal diameter of start shaft and target shaft	Shaft bottom: DN 800 Inlet set/outlet set: DN 600			
Connection DN Inlet / outlet:	Connection set DN 315: Solid-wall pipe connection inlet/outlet DN/OD 315 Connection set DN 400: Solid-wall pipe connection inlet/outlet DN/OD 400 Connection set with additional connection at the inlet: Solid-wall connection inlet 2x DN/OD 315 and 1x DN/OD 400, outlet DN/OD 400			
Miscellaneous:	For planning details, see CAD drawings Installation according to "SediPipe L and SediPipe L plus" installation and maintenance manual			 <a href="http://www.fraenkische.com">www.fraenkische.com</a>